



Cordless Hedge Trimmer

DUH507 500 mm (19-3/4")

DUH607 600 mm (23-5/8")

Satisfy Professional's Needs



photo: DUH507



photo: DUH607



photo: DUH507



DUH507
500mm

DUH607
600mm

Run time*
DUH507/DUH607
77/60 min
Battery: BL1830B

Strokes per minute
2,700 min⁻¹

Net weight
3.0 kg
Battery: BL1860B
Model: DUH507



*Continuous run time on a single full battery charge

Lightweight design



Improved trimming performance

The performance to guide twig/branch towards blade tooth has been improved by:

- shortening the length covered by blunt extension
- tapering the tip of blunt extension

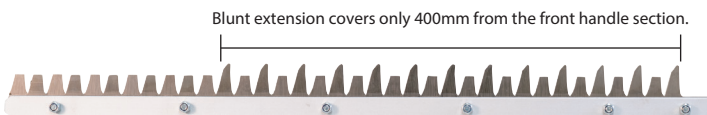

Maximum branch diameter
15.0 mm



Large main switch lever
for improved switch operation



eXtreme Protection Technology

Chip receiver (option)

can make it easier for user to collect leaf and twig debris, thanks to:

- Lower height of the connecting levers
- Reduced step height of the edge of the chip catching plate

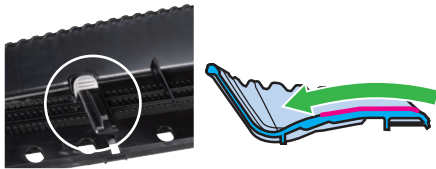

Highly durable crank mechanism

Increased crank wall thickness can:

- reduce the chance of falling off of the blade from the crank.
- increase the contact area between the crank and blade, reducing wear of the crank.



Easy-to-press front switch lever

Front switch lever has been redesigned to be easily pressed even when it is gripped at the side.

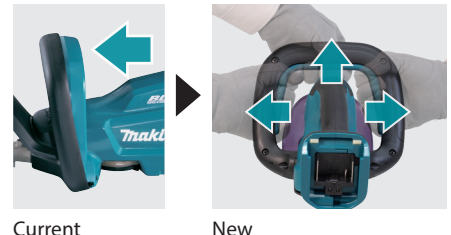

Accessories

Shear blade set



Blade cover



Chip receiver



Model No.	Shear blade set	Blade cover	Chip receiver
DUH507 (500mm)	1911J1-6	413L91-8	1910T1-0
DUH607 (600mm)	1911J2-4	413L92-6	1910T2-8

Charging Time

	Fast Charging	
	DC18RC	DC18SD
BL1815N 1.5Ah	15 min	30 min
BL1820B 2.0Ah	24 min	45 min
BL1830B 3.0Ah	22 min	60 min
BL1840B 4.0Ah	36 min	90 min
BL1850B 5.0Ah	45 min	110 min
BL1860B 6.0Ah	55 min	130 min

Cordless Hedge Trimmer

DUH507 500 mm (19-3/4") / DUH607 600 mm (23-5/8")

	DUH507	DUH607
Brake		
Blade length	500 mm (19-3/4")	600 mm (23-5/8")
Max branch dia.	15 mm (9/16")	15 mm (9/16")
Strokes per minute (SPM)	2,700	2,700
Continuous use (min)	w/ BL1830B: 77	w/ BL1830B: 60
Vibration Level	Front/Rear: 1.1/0.6 m/s ²	Front/Rear: 1.2/0.7 m/s ²
Sound Pressure Level	74 dB(A)	73 dB(A)
Sound Power Level	85 dB(A)	84 dB(A)
Dimensions (L x W x H)	w/o Battery: 872 x 209 x 188 mm (34-1/4 x 8-1/4 x 7-3/8")	w/o Battery: 976 x 209 x 188 mm (38-1/2 x 8-1/4 x 7-3/8")
	w/ BL1815N / BL1820B: 909 x 209 x 188 mm (35-3/4 x 8-1/4 x 7-3/8")	w/ BL1815N / BL1820B: 1,013 x 209 x 188 mm (40 x 8-1/4 x 7-3/8")
	w/ BL1830B / BL1840B / BL1850B / BL1860B: 925 x 209 x 188 mm (36-1/2 x 8-1/4 x 7-3/8")	w/ BL1830B / BL1840B / BL1850B / BL1860B: 1,029 x 209 x 188 mm (40-1/2 x 8-1/4 x 7-3/8")
Net weight	2.7 - 3.0 kg (6.0 - 6.6 lbs.)	2.8 - 3.1 kg (6.2 - 6.8 lbs.)

Standard Equipment : Blade cover, Battery, Charger

The weight may differ depending on the attachment(s), including the battery cartridge. The lightest and heaviest combination, according to EPTA-Procedure 01/2014, are shown in the table. Items of standard equipment and specifications may vary by country or area.

Makita Corporation

3-11-8 Sumiyoshi-cho, Anjo, Aichi, 446-8502 Japan

PRINTED IN JAPAN 202301