

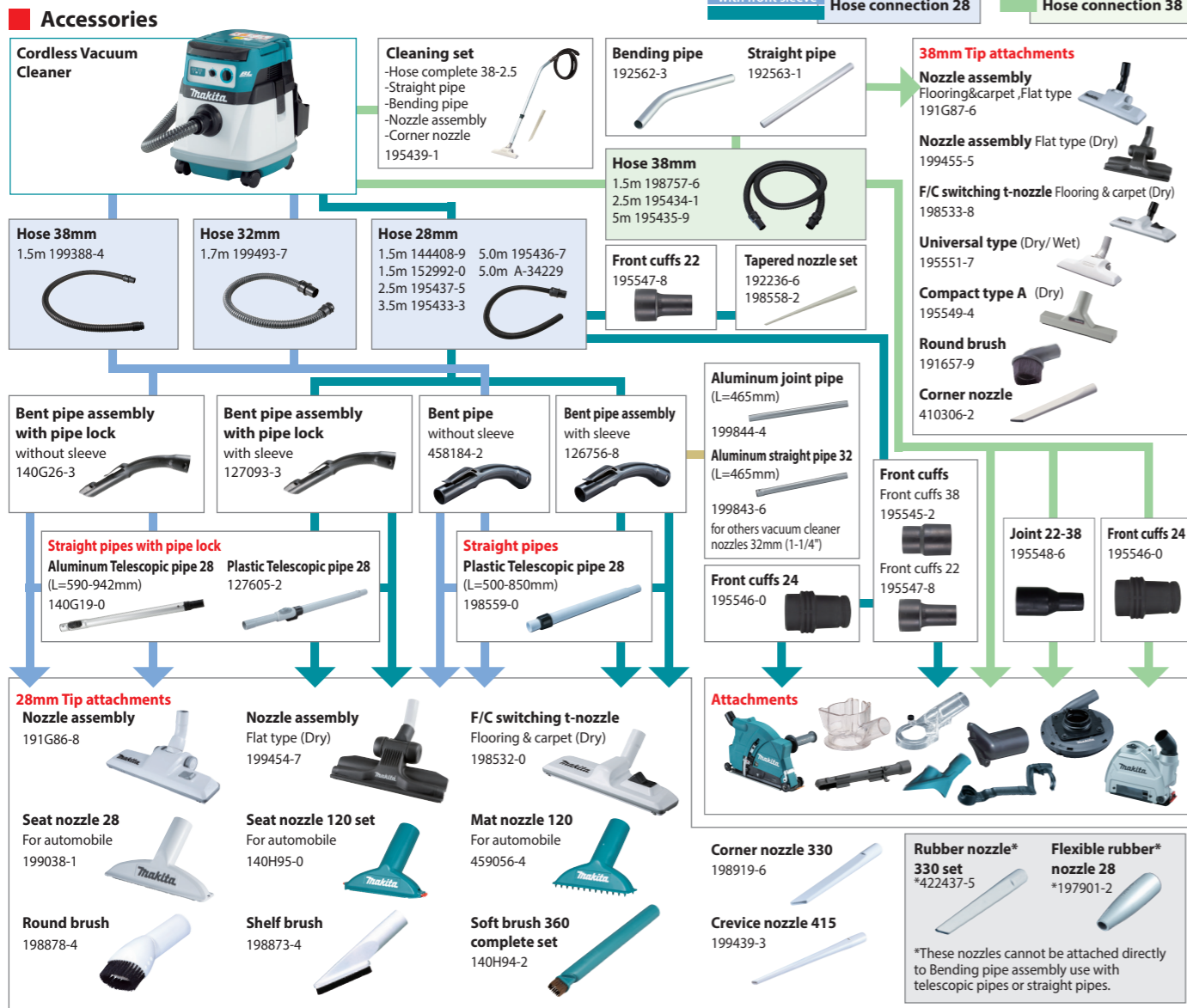

# Cordless Vacuum Cleaner Series

DVC155L / DVC156L / DVC157L **15L**  
 DVC865L / DVC866L / DVC867L **8L**



## Cordless Vacuum Cleaner

### DVC155L / DVC156L / DVC157L / DVC865L / DVC866L / DVC867L

	DVC155L / DVC156L / DVC157L	DVC865L / DVC866L / DVC867L
Variable Speed		
Revolving Hose		
Static Free Hose		
<b>Capacity</b>	DVC155L: Dust / Water: 15 / 12 L DVC156L / DVC157L: Dust: 15 L	DVC865L: Dust / Water: 8 / 6 L DVC866L / DVC867L: Dust: 8 L
<b>Continuous Use (min.)</b>	w/ BL1860B: 100	w/ BL1860B: 100
<b>Max Air Flow</b>	DVC155L / DVC156L: 2.1 m³/min, DVC157L: 2.4 m³/min	DVC865L / DVC866L: 2.1 m³/min, DVC867L: 2.4 m³/min
<b>Max Sealed Suction</b>	11 kPa	11 kPa
<b>Suction Power</b>	DVC155L / DVC156L: 105 W / DVC157L: 110 W	DVC865L / DVC866L: 105 W / DVC867L: 110 W
<b>Vibration Level</b>	2.5 m/s² or less	2.5 m/s² or less
<b>Sound Pressure Level</b>	70 dB(A) or less	70 dB(A) or less
<b>Dimensions (L x W x H)</b>	366x334x421 mm (14-3/8"x13-1/8"x16-1/2")	366x334x368 mm (14-3/8"x13-1/8"x14-1/2")
<b>Net weight</b>	DVC155L: 7.2 - 7.9 kg (15.9 - 17.4 lbs.) / DVC156L: 7.3 - 7.9 kg (16.1 - 17.4 lbs.) DVC157L: 8.0 - 8.6 kg (17.6 - 19.0 lbs.)	DVC865L / DVC866L: 7.0 - 7.7 kg (15.4 - 17.0 lbs.) DVC867L: 7.7 - 8.4 kg (17.0 - 18.5 lbs.)

**Standard Equipment:** Plastic Dust Bag x10, Tool Box, Battery, Charger, Wireless Unit (DVC157L/DVC867L)  
**Country-specific:** Hose Complete, Telescopic Pipe Assembly, Bent Pipe, Pipe, Long Sash Nozzle, Nozzle Assembly, Corner Nozzle, Front Cuffs (22, 24, 38)

The weight does not include accessories but battery cartridge(s). The lightest and heaviest combination weight of the appliance and battery cartridge(s) are shown in the table.  
 Items of standard equipment and specifications may vary by country or area.



18v + 18v → 36v

# High power & Low noise



**Max sealed suction**  
**11 kPa**  
 Dial mode: 5

**Low noise**  
**55 dB**  
 Dial mode: 1

**BL MOTOR XPT AWS HEPA filter**  
 [DVC157L / DVC867L only]

**Makita Corporation**  
 3-11-8 Sumiyoshi-cho, Anjo, Aichi, 446-8502 Japan

# Makita low noise vacuum cleaner series

Max sealed suction  
11 kPa

Dial mode: 5

Low noise  
55 dB

Dial mode: 1

Increased suction power achieved by redesigned motor

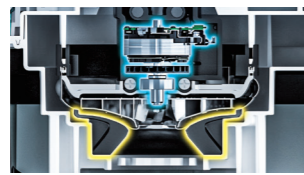

Large on-off switch allows for easy on/off switching



Main power switch

Variable suction power control by dial  
Suction power is variably adjustable to suit application.

**BL MOTOR**  
Brushless motor

New cloth filter for dry use designed for the building maintenance industry  
DVC156L / DVC866 only  
Features a simple structure assuming use of paper dust bag.

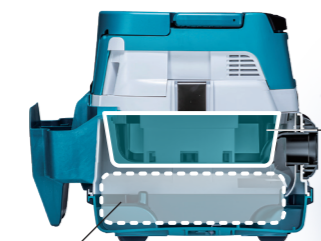

Paper dust bag Cloth filter set

Telescopic pipe with lock  
• A locking mechanism has been added to the connection of bending pipe and this pipe to prevent from falling off.  
• Available in lightweight plastic and rigid aluminum

Telescoping button slide button style

Mode switching lever

For hard floor For carpet



48mm



Low noise  
Disturbing noises like wind noise have been reduced by redesigning air vents and air paths.



Designed to run stably  
A support leg with two rollers has been added to tool box. When you run the cleaner by pulling the hose, the rollers prevent it from tipping over backward.



Continuous use  
100 / 40 min

Dial mode: 1 / 5  
Battery: BL1860B x 2  
ø32 x 1.7m hose

For Cleaning



Photo: DVC865L

For Dust Collecting



Photo: DVC867L

For Cleaning

Wet & Dry

**BL XPT**

Dry only

**BL XPT**

DVC155L

Tank capacity  
15 L

DVC865L

Tank capacity  
8 L



DVC156L

Tank capacity  
15 L

DVC866L

Tank capacity  
8 L



For Dust Collecting

Dry only

**AWS BL XPT**

DVC157L

Tank capacity  
15 L

DVC867L

Tank capacity  
8 L



**AWS** Auto-start Wireless System  
DVC157L / DVC867L only

The wireless activation function enables clean and comfortable operation. By connecting a supported tool to the cleaner, you can run the cleaner automatically along with the switch operation of the tool.



**Bluetooth** AWS connects to power tool with Bluetooth  
The Bluetooth® word mark and logos are registered trademarks owned by the Bluetooth SIG, Inc. and any use of such marks by Makita is under license. Other trademarks and trade names are those of their respective owners.